



PNEUMATIC
PINCER Type GRIP
Model MPN/1 (1 kN)



Lightweight pneumatic clamping grip, easy to use and applicable to perform **extraction tests** of elements that are difficult to access, or by using 2 grips, **tensile tests** of very small specimens can be made, being incorporated into a Universal Testing Machine.

GENERAL INFORMATION

Lightweight, easy-to-use pneumatic grip designed for the extraction tests of elements in difficult accesses or (using 2 grips) to perform the classic tensile tests of specimens or very small and low-resistance sheet materials up to **1 kN**.

MODEL	MPN/1
• Load capacity:	1 kN
• Clamping force:	2 kN horizontal (at 7 Bar)
• Opening:	0-6 mm
• Body:	Anodized Aluminium
• Temperature range:	0... + 70 ° C Other ranges on request
• Clamping surface:	5 x 5 mm
• Pneumatic connection	1/8 "internal thread
• Weight per grip:	0,80 Kg (with jaws)
• Scope of delivery	1 grip (withot jaws) Order separately

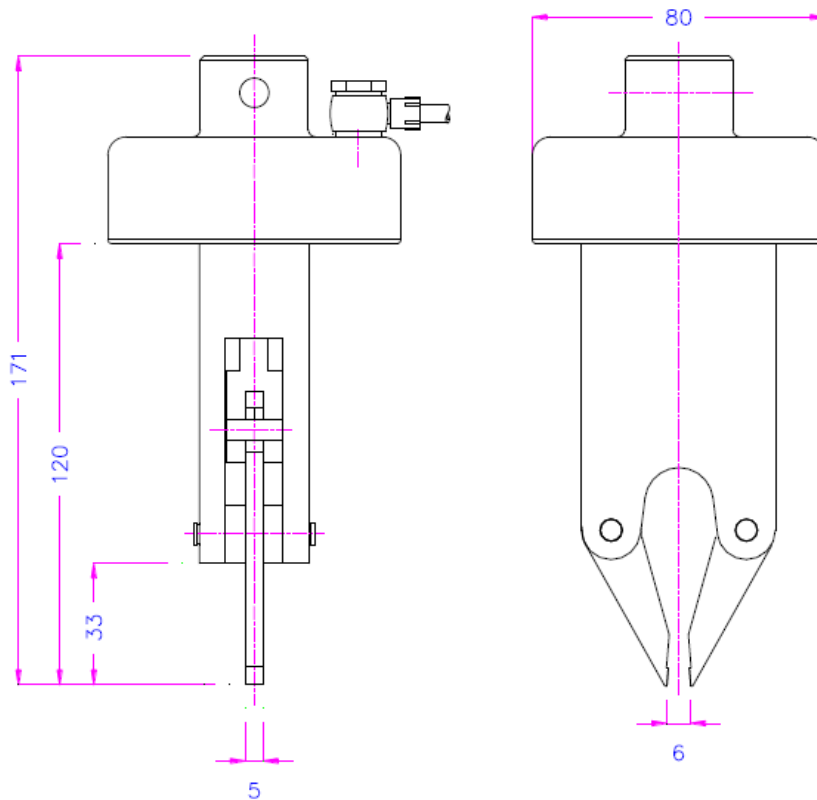

Jaws for Grip MPN/1: Scope of delivery 1 set = 2 jaws

Model	Surface finish	Clamping surface Height x width	Opening
MPN/1-B	Blank jaws	5 x 5 mm	0 – 6 mm
MPN/1-BP	Pyramid jaws	5 x 5 mm	0 – 6 mm
MPN/1-BD	Diamond jaws	5 x 5 mm	0 – 6 mm



Blank jaw

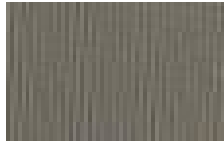

Pyramid jaw 0.3x45°



Diamond jaw

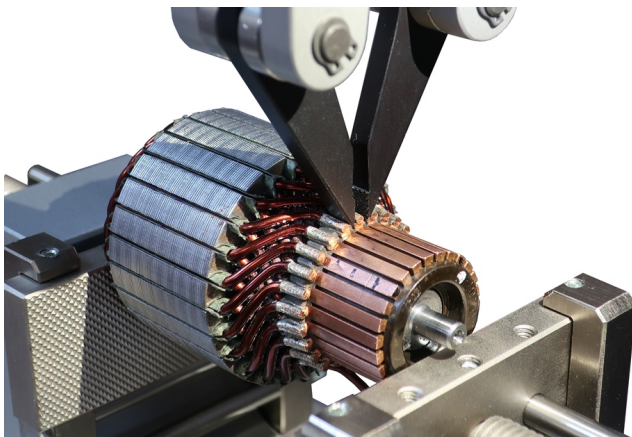

Welded Joints Tests



TitanNitride coated jaws



Similar grips:



MTP/100-6-K-MB



MCL



MTP/20



MMP/2

PNEUMATIC ACCESSORIES:

UN205-1 Foot pedals

None-locking: The grip jaws open by pressing the foot pedal and close after removing the foot from the pedal.

Scope of delivery: 1 pair of foot switches including tubes and fittings

UN205-2 Foot pedal

With locking function: The grip jaws open by pressing the foot pedal and remain opened after removing the foot from the pedal. The jaws close by pressing the pedal one more time.

Scope of delivery: 1 pair of foot switches including tubes and fittings

UN205-.+PR16bar Pressure regulator

Optional for UN205-1 o UN-205-2

To adjust air pressure: 1-16 bar

UN205-3 Hand switches

With locking function: The jaws of the grip close by pulling the handle and remain closed. The jaws open by pushing the handle back.

Scope of delivery: 1 unit of hand switches including tubes and fittings

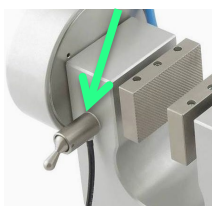
UN205-4-M5 Handheld Micro-Switches

Pneumatic manual microswitches, tubes and fittings, M5 pneumatic connection

With lockout feature: Manual switches mount directly to handles (1/8" couplings only), 3/2 directional valve. Only for single action rods with spring inside.

Scope of supply: 2 manual switches including tubes and accessories

UN216 Silent compressor for laboratories, oil-lubricated, with pressure reducer

Max pressure 16 bar; 230 V/50 HZ; noise level: 38 dB(A)

Motor: 0.13 kW; displacement: 17 l/min; tank size 3.5 l Dimensions: 340x290x340 mm (L x W x H); weight 18 kg

Different voltages on demand